

Kids PROJECTS™

POPSTICK STATIONERY HOUSE

INSTRUCTIONS

STEP 1 LAY OUT PIECES

Check you have all the contents as listed below:

- | | |
|------------|-----------------------|
| Popsticks | Colour-in card pieces |
| Glue tubes | Folded card shop |
| Pompoms | Instruction sheet |
| Markers | |

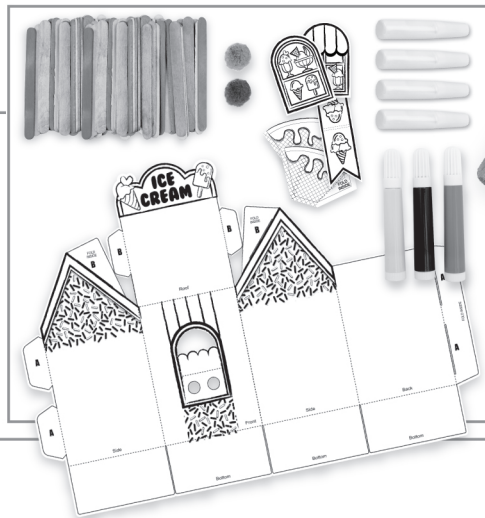

STEP 2 GLUING



Build the walls of your ice cream shop!
Lay your folded card shop on a flat surface. Choose your popsticks, and glue them to the blank wall areas. Make sure that you glue the popsticks between the dotted lines.

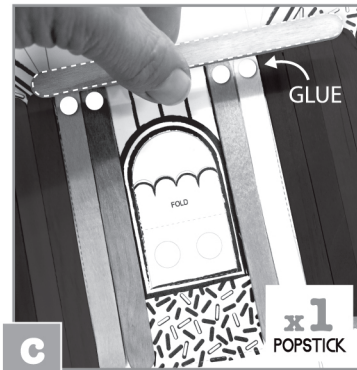

Make a hanging sign for your ice cream shop!
Put a small amount of glue dots on the top of the 4 popsticks on the front wall of the card shop. Make sure you don't glue it to the side wall. The popstick should align like the picture above. Push down gently to ensure that it is glued in place and wait to dry.

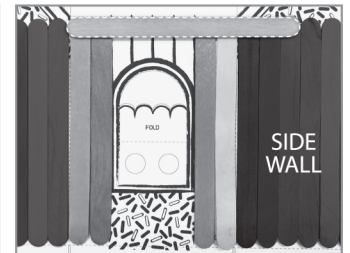

Result

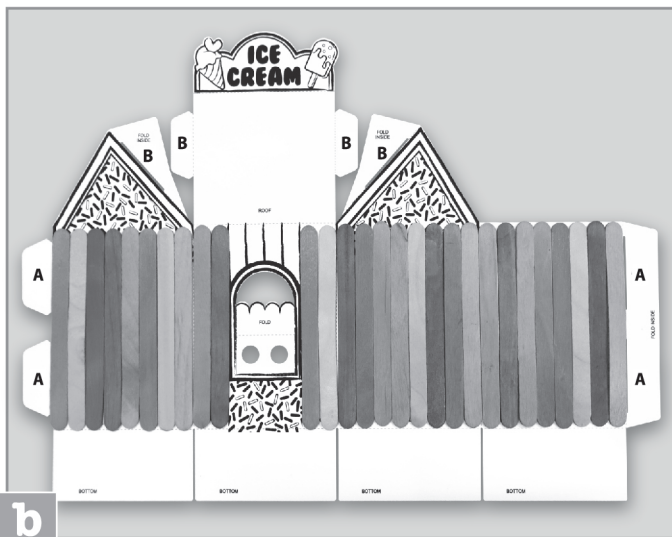

When you have finished gluing your walls, it should look like the above picture. Keep the card shop on a flat surface.

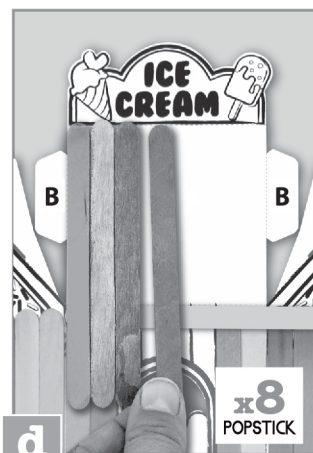

Build a roof!
Make sure that the glue has dried the popsticks to the walls before you construct the roof. Add glue to the blank roof area of the card shop. Carefully glue the 8 popsticks in place. Make sure that the popsticks are not glued to the front of the shop. Allow to dry.

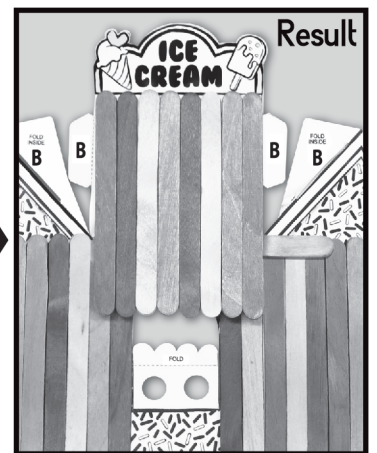

Result

STEP 3 FOLDING

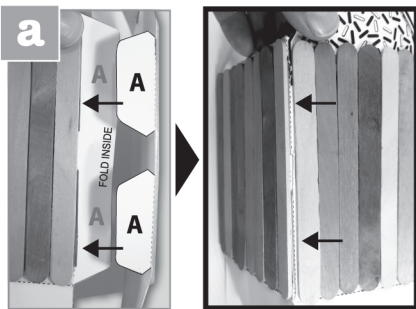

Construct!
Once your popsticks have dried in place, you can build your shop. Fold both A tabs and fit them into the slots labelled A, (popsticks facing out).

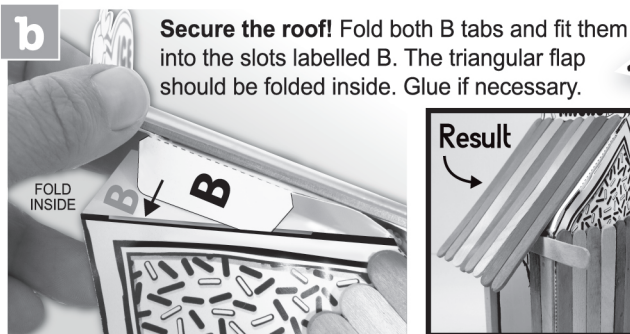

Secure the roof! Fold both B tabs and fit them into the slots labelled B. The triangular flap should be folded inside. Glue if necessary.

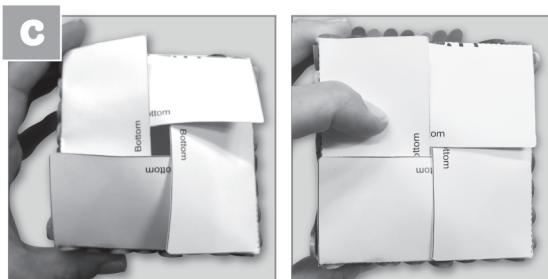

Fix the flooring!
Turn your ice cream shop upside down. Fold each of the bottom flaps as shown in the picture. Fix with glue.

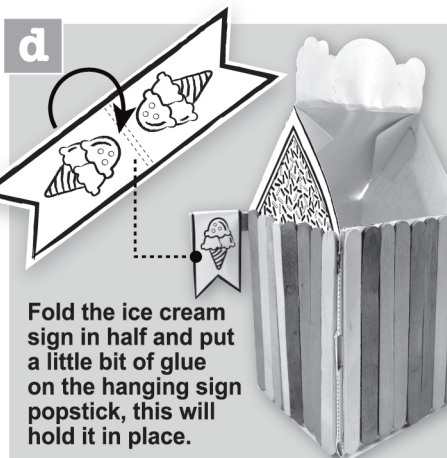

Fold the ice cream sign in half and put a little bit of glue on the hanging sign popstick, this will hold it in place.

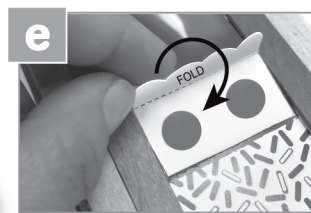

Build a bench!
Fold the tab along both dotted lines so that it sits outside the window. The ice creams will go in the holes.



STEP 4 MAKING & DECORATING

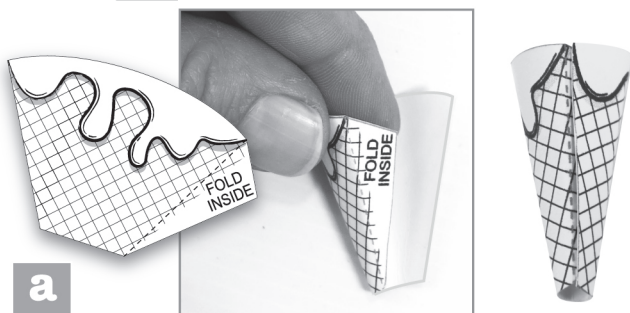

Make your ice creams! Using your finger roll and curve the paper ice cream cones. Fold the tab inside and glue in place. Fasten with tape if necessary.

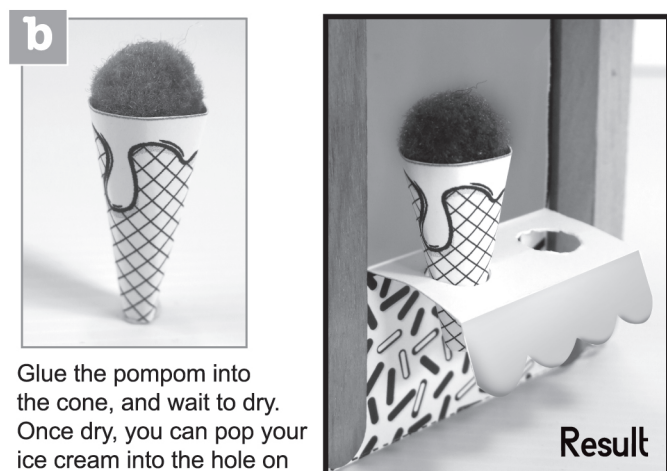

Glue the pom-pom into the cone, and wait to dry. Once dry, you can pop your ice cream into the hole on the window bench.

STEP 5 COLOURING

Using the markers, colour in your ice cream shop, walls, windows, signs, ice cream cones and more. Glue the colour-in pieces in place, and wait to dry.



STEP 6 DISPLAYING

Your ice cream popstick house is now ready to display! Store your pencils, markers, scissors and stationery into the back of the shop.

* Seek adult assistance when cutting if needed.



POPSTICK STATIONERY HOUSE

GO GREEN

Tips for sustainability



Sell or donate your creation rather than landfilling it if possible.



Dispose of packaging responsibly*



***Check with your local authority for further information on responsible recycling.**



WARNING:
CHOKING HAZARD - Small Parts.
Not suitable for children under 3 years.

CAUTION Keep out of reach of young children. Keep away from food, drink and animals. When using glue and markers, ensure carpets, clothes and furniture are protected. Avoid contact with skin and eyes. In case of contact with eyes, rinse immediately with plenty of water and seek medical advice immediately and show this label. Please remove all packaging attachments before giving to child. Not suitable for children under 3 years! Retain this package for future reference. Colour and shape of contents may vary. Adult supervision required.



Created by © Colorific
Colorific Australia: 1800 801 545
info@colorific.com.au

www.colorific.com.au
Designed in Australia MADE IN CHINA

Item No. I77289